

The Ranch, Larimer County's Events Complex, is located in Loveland, Colorado and is owned by Larimer County. The Ranch is Northern Colorado's premier multi-purpose entertainment and agricultural complex with over 375,000 sq. ft of versatile indoor and outdoor event space and host to over 1,000 events per year. Built in 2003, The Ranch Events Complex is located adjacent to I-25 and US 34 just 50 miles north of Denver International Airport and a short drive to Estes Park and Rocky Mountain National Park.

This state-of-the-art complex is located within 8 miles of downtown Loveland, and is near Fort Collins, Greeley, and Windsor. The Ranch is easy to access and has hotels within walking distance which makes it the perfect site for not only local events, but regional, and national events as well!



Ranch Landmark

The Ranch facilities are ideal for:

- Business meetings and educational events
- Conferences and trade shows
- Automotive, boat, and motorcycle shows
- Home improvement and garden shows
- Charity and fundraising events
- Company picnics and parties
- Sporting events and competitions
- Club meetings and rallies
- Outdoor festivals and campus wide events
- Equine, livestock, and small animal shows
- Receptions



Northern Colorado's Largest Events Complex

The Ranch Events Complex provides more than 375,000 sq. ft of versatile event space including:

Blue Arena

6,800-seat arena

- HomeRun Bar & Grill: 3,500 sq. ft.

Pedersen Toyota Center

(2) 18,000 sq. ft. Exhibition Halls

(3) Larimer County Conference Center

Meeting Rooms: 1,775 sq. ft.

Thomas M. McKee 4-H, Youth & Community Building

12,500 sq. ft. Exhibition Hall

- 6 adjoining meet rooms

MAC Equipment, Inc. Indoor Arena and Pavilions

• Indoor Arena:

62,000 sq. ft., with 150' x 300' arena floor

• The Ranch Indoor Warm-Up Arena: 22,000 sq. ft., with 92' x 253' arena floor

• (2) Livestock Pavilions:

38,000 sq. ft. each, 320 stalls combined

Outdoor

- Over 2400 paved parking spaces
- 121 RV Sites
 - 81 Electric
 - 40 Full Hook-up
- Over 60 acres of grassland and 12 acres of landscaped courtyard

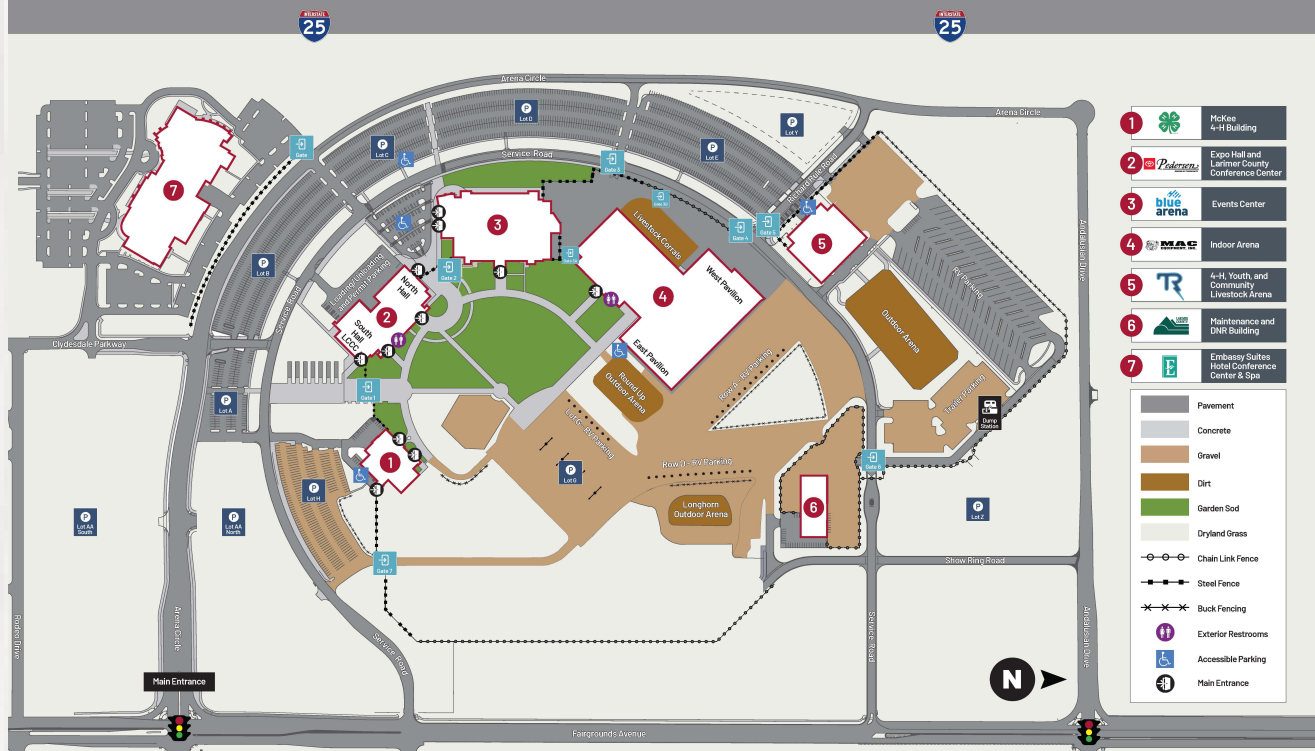

The Pedersen Toyota Center has a combined 38,000 sq. ft. of versatile event space, which makes the building the perfect location for trade shows, banquets, large-scale group presentations and conferences. This space can be further subdivided into 18,000, 12,000, and 7,000 sq. ft. spaces. Each hall can accommodate 85 10x10 booths. Adjacent to the South Exhibition Hall are the Cross and Rodenberger meeting rooms and the Larimer County Conference Center. The Conference Center is equipped with LED television screens and WiFi.



Banquet Event

Ancillary Rentals Include

- Tables and Chairs • Podiums • Staging • Audio Visual Equipment • Whiteboards • Easel
- Pipe and Drape • Lighting • Holiday Decor

SUGGESTED CAPACITY

VENUE	SQ. FT.	SUGGESTED CAPACITY			CEILING HEIGHT
		BANQUET	THEATER	CLASSROOM	
South Exhibition Hall (Cowley & Morehouse combined)	18,000	600	1,000	600	Low 14' High 36'
Cowley Hall	12,000	300	600	360	
Morehouse Hall	7,000	200	400	240	
North Exhibition Hall	18,000	600	1,000	624	Low 14' High 38'
Cross Room	530	20	40	24	
Rodenberger Room	530	20	40	24	
Cross & Rodenberger Rooms	1,060	30	80	48	
Larimer County Conference Center (Brown, Beard, & Sandhouse Combined)	1,775	75	180	83	
Brown Room	600	32	60	27	
Beard Room	625	32	60	27	
Sandhouse Room	550	24	60	25	

Pedersen Toyota Center



Exterior of Pedersen Toyota Center



Trade Show

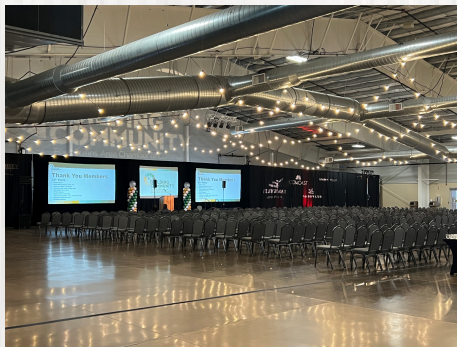

Conferences

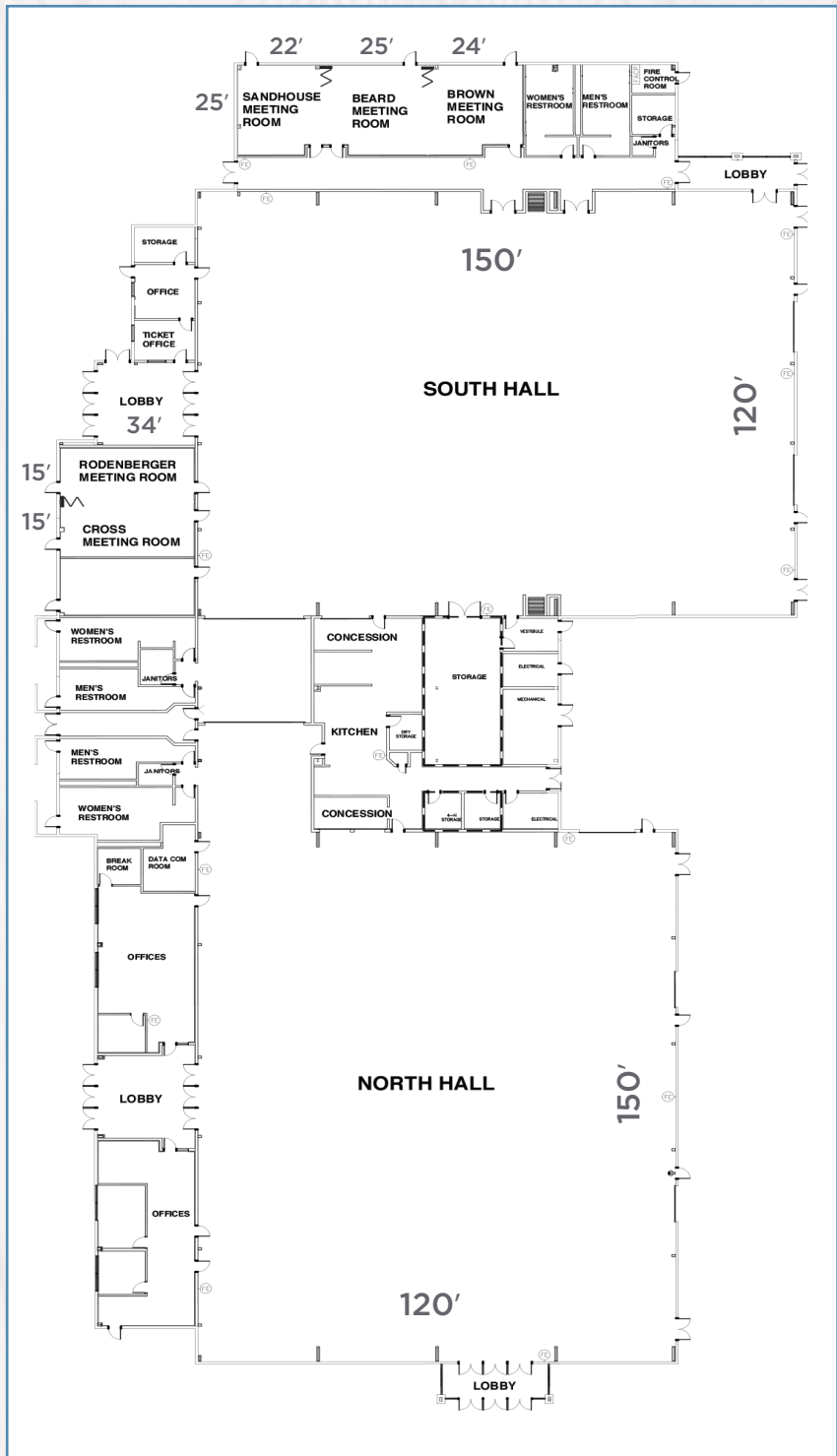

Larimer County Conference Center

Adjacent to the Pedersen Toyota Center South Hall, is the Larimer County Conference Center. The conference center meeting rooms are suitable for meetings, trainings, and educational events. Meeting rooms are equipped with WiFi, high definition television screens, tables, and chairs.



Meetings



Conference Center Entrance



"Everyone was so easy to work with! Your coordinator orchestrated our event and did a spectacular job! Your Operations Staff had everything ready for us when we arrived and they were wonderful to work with. They were always available and happy. The food selections were delicious. Thank you so much - it was our best year ever!"

Applewood Arts

VENUE	SQ. FT.	SUGGESTED CAPACITY		
		BANQUET	THEATER	CLASSROOM
Larimer County Conference Center (Brown, Beard, & Sandhouse combined)	1,775	75	180	83
Brown Room	600	32	60	27
Beard Room	625	32	60	27
Sandhouse Room	550	24	60	25

The Ranch Events Complex provides in-house event coordinators to ensure your event is organized and executed professionally. Your event coordinator recommends room layouts, facility planning, marketing assistance and more. The facilities team at The Ranch can provide additional technical equipment and support.

Ancillary rentals include:

- Podiums & public address systems
- Complimentary and upgraded WiFi
- Tables & chairs
- Pipe and Drape
- Staging

The Ranch partners with specialty event companies and vendors, which can provide additional lighting, decor, DJs, casino tables, carriage rides, tents, decor, audio visual, entertainment and more to help you customize your event!



Wagon Rides



Entertainment



Casino Tables



Outside Tent



"We have used your facility for past events and you all have been awesome! Thank you so much for making it so easy and stress free for me. We will be scheduling future events soon!"

Banner Health Medical Center

MAC Equipment, Inc. Indoor Arena and Livestock Pavilions

The MAC Equipment Inc. Indoor Arena and Livestock Pavilions is Northern Colorado's Premier Equine and Livestock facility with 159,000 sq. ft. under one roof. The East and West Pavilions have 350 10x10' rubber-matted stalls and wash racks with hot and cold water. The indoor arena has state-of-the-art footing engineered by Bob Kaiser and maintained by a skilled arena team. The building includes bleacher seating for 1,000, a concourse, a show office, a judge's office, restrooms, and shower facilities. Our on-site catering and concessions provider operates full-service concession stands.

RV Camping is available with electricity, water, and sewer hookups, as well as a dump station and water filling station.

- 54 Electric Only
- 40 Full Hookups
- 14 In Row E + 14 in Row F (availability depends on event)



Indoor Arena



Equine and Livestock Events

VENUE	SQ. FT.	SIZE	ARENA	BLEACHER SEATING	OVERHEAD DOORS
MAC Equipment, Inc. Indoor Arena	62,000	200'x360'	150'x300'	1,200 People	18'x18' (2) 16'x14' 18'x14' (4)
The Ranch Warm-Up Arena	27,686	109'x254'	92x253		18'x18' (2)
MAC Equipment, Inc. East Livestock Pavilion	38,000	252'x151'			12'x14' (9) 14'x16' (4)
MAC Equipment, Inc. West Livestock Pavilion	38,000	252'x151'			12'x14' (9) 14'x16' (4)

MAC Equipment, Inc. Indoor Arena and Livestock Pavilions



10x10 Stalls in Pavilion



MAC Equip Inc. Arena

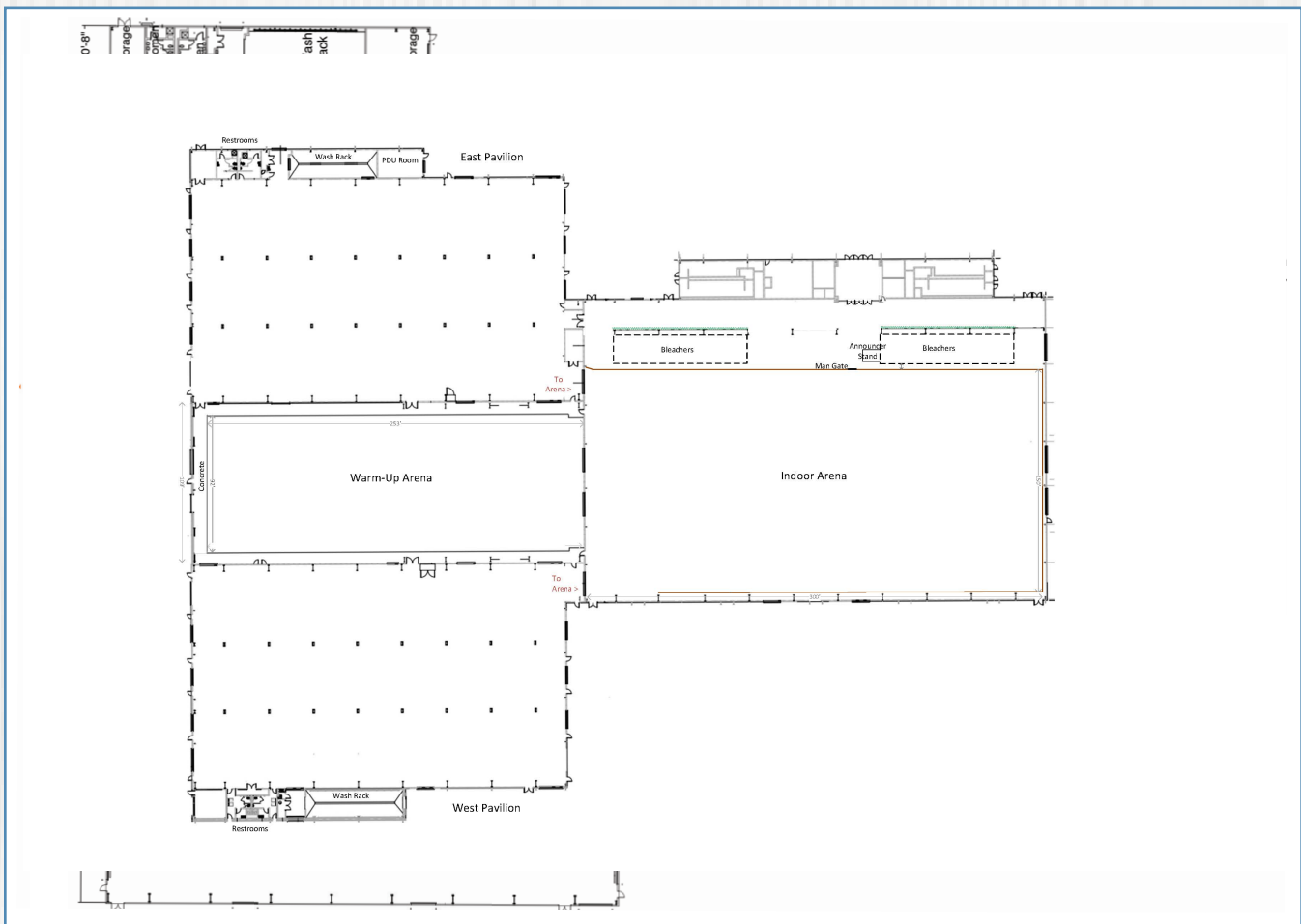

Thomas M. McKee 4-H, Youth and Community Building

The McKee Exhibition Hall offers 12,500 sq. ft. of event space which can be further subdivided into 7,500, 3,000, and 2,000 sq. ft. spaces and can accommodate 50 10x10 booths. Adjacent to the halls are six meeting rooms with windows that can

be configured to accommodate your specific needs.



McKee Meeting Room



McKee Building

SUGGESTED CAPACITY

VENUE	SQ. FT.	SUGGESTED CAPACITY			CEILING HEIGHT
		BANQUET	THEATER	CLASSROOM	
McKee Exhibition Hall	12,500	400	995	418	
McKee Exhibition Hall A (sub-divided)	7,500	250	625	230	Low 13' High 32'
McKee Exhibition Hall B (sub-divided)	2,000	64	130	60	Low 13' High 26'
McKee Exhibition Hall C (sub-divided)	3,000	88	240	128	Low 13' High 26'
McKee Exhibition Hall B & C (sub-divided)	5,000	150	370	188	
Fort Collins Room	1,120	40	54	42	
Loveland Room	1,120	40	54	42	
Berthoud Room	1,120	40	54	42	
Fort Collins/Loveland/Berthoud Rooms	3,360	120	162	126	
Laporte Room	840	32	40	36	
Timnath Room	840	32	40	36	
Estes Park Room	840	32	40	36	
LaPorte/Timnath/Estes Park Rooms	2,520	96	120	105	

Thomas M. McKee 4-H, Youth and Community Building



Banquet Event



McKee Building



McKee Interior

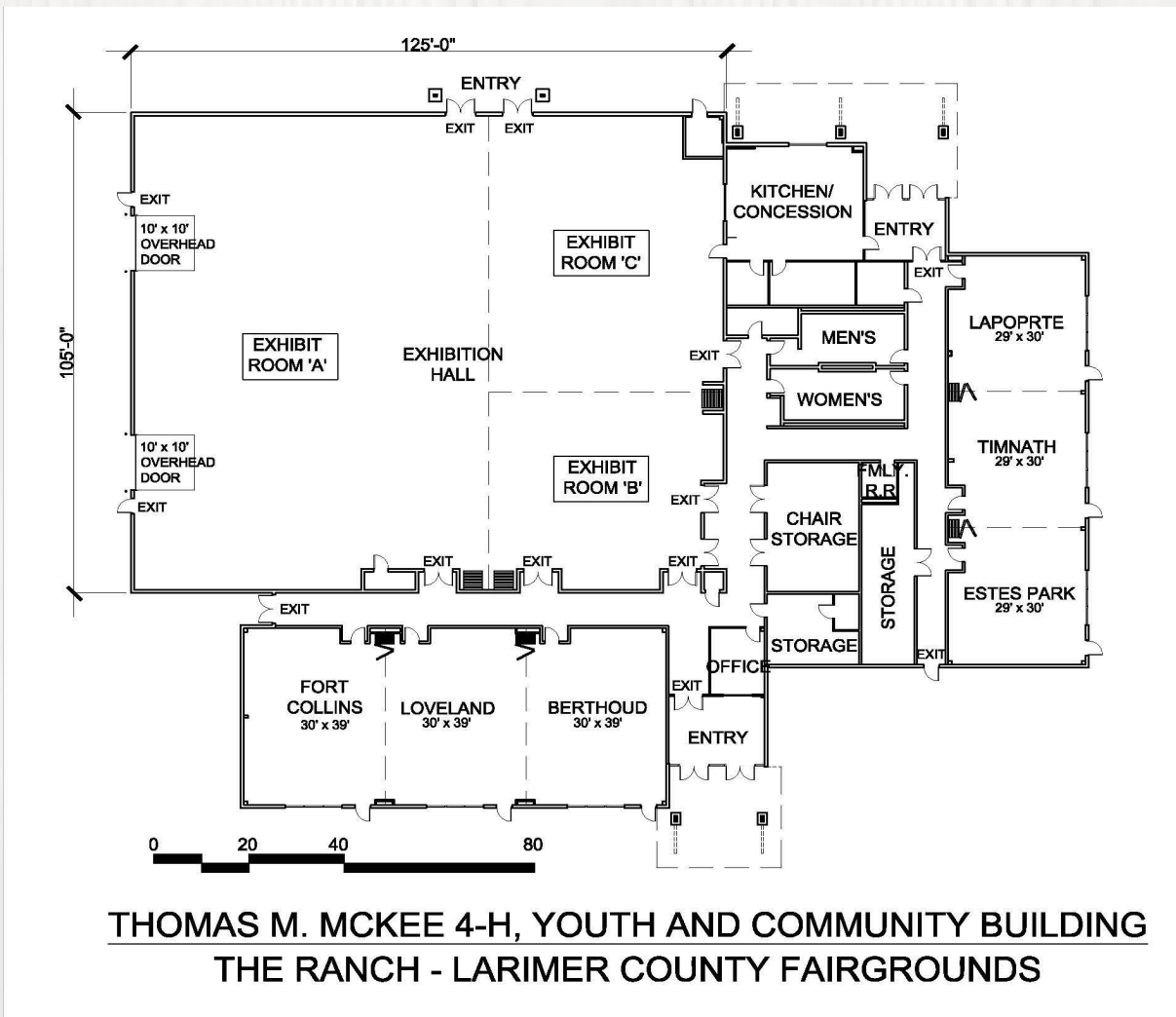

Blue FCU Arena is a 6,800-seat multi-purpose arena and events facility located on The Ranch campus. The Arena hosts over 650,000 guests per year.

The venue is managed by Oak View Group, the fastest-growing firm in the public assembly facility management field with multiple facilities throughout the world.

This multi-purpose facility is home to the Colorado Eagles AHL Hockey team, and hosts multiple concerts, family shows, thrill shows, rodeos, trade shows, and more. Several dozen configurations accommodate a variety of events.

Blue FCU Arena also offers great locations to host your next meeting, corporate function or party. The Home Run Bar & Grill is located on the 4th Floor Suite Level and can accommodate a variety of events. Entertain your clients, friends or colleagues in style in one of the luxury suites or on the Voodoo Ranger Lounge during a game. The group discounted ticket program at the Arena is a great way to take advantage of special ticket pricing.



Hosts Over 650,000 Guests per Year



Home of The Colorado Eagles



Cirque du Soleil



Rodeo



Luxury Suites

The HomeRun Bar & Grill on the suite level of the Arena offers breathtaking views of the Rocky Mountains. It can accommodate up to 130 guests, has full audio/video capabilities and complimentary WiFi. It is available for private functions such as meetings, holiday parties, receptions, and corporate events.



Formal Events

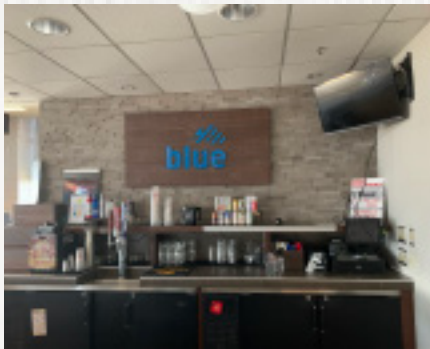

HomeRun Bar & Grill

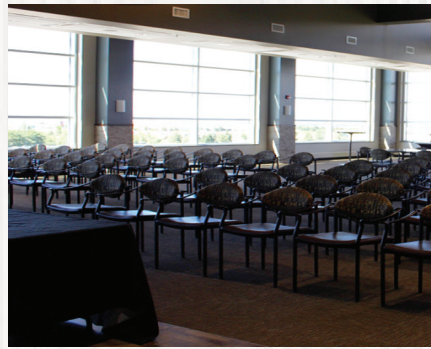

Meetings



Social Events



“The Northern Colorado Home Builders Association was proud to hold our annual Parade of Homes Awards Dinner at The HomeRun Bar & Grill. The set-up worked out perfectly, the staff was exceptional, friendly and very helpful in accommodating any type of event that you may want to have. There were 130 attendees that were managed comfortably and we will continue to book these types of events there. The location is convenient, plenty of parking and there is a great selection of food choices through Spectra. Sponsors, attendees and speakers were all very impressed and pleased to have the event there.”

Northern Colorado Home Builders Association

VENUE	SQ. FT.	SUGGESTED CAPACITY	
		BANQUET	THEATER
HomeRun Bar & Grill	3,500	120	200

The Ranch campus sits on a total of over 240 acres and is ideal for most outdoor events. The courtyard and grassy areas are great for outdoor events, concerts, festivals, private parties, summer picnics and sporting events. The grassy courtyard and gravel areas have access to electrical vaults for vendors, stages, and more!



375,000 Square Feet of Event Space

The Ranch campus has plenty of free parking that is easy to access. The Ranch also hosts many self-promoted events throughout the year, like the Larimer County Fair!



Concerts

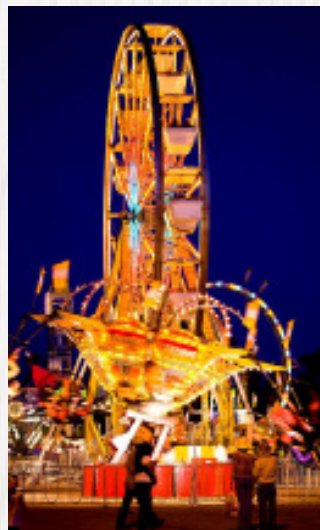

Larimer County Fair

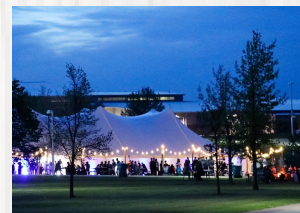

Outdoor Events



Car Shows

OUTDOOR AREAS	ACRES	SQ. FT.
Full Courtyard	11.8	514,803
Bowl Interior Section	2.84	125,645
Corral Section	1.12	49,275
Triangle Section	.97	42,115

OVG Hospitality is the exclusive food and beverage provider at The Ranch Events Complex. OVG brings catering to the next level and is recognized across North America for providing quality food coupled with impeccable service.

OVG Hospitality's approach is to ensure that food reflects the flavors, quality and authenticity of the many fine restaurants in Colorado.

The Executive Chef and catering staff enjoy creating custom menus to meet the needs of each guest. OVG is skilled at providing catering and concession services for the small intimate gathering as well as large scale events.

Specializing in:

- Action Stations
- Buffet-style options
- Four-course plated meal
- Receptions
- Banquets



Dessert Bar



Holiday Buffet



Receptions



Formal Event